



naomi j ryan
estate agents



House - Terraced



Bedrooms: 2



Bathrooms: 1



Receptions: 1



EON District Heating



2 Allocated Parking
Spaces



Rear Garden



Council Tax Band: C

£260,000 Freehold



Myrtlebury Way,
Hill Barton, Exeter, EX1 3GA

www.naomijryan.co.uk

GROUND FLOOR

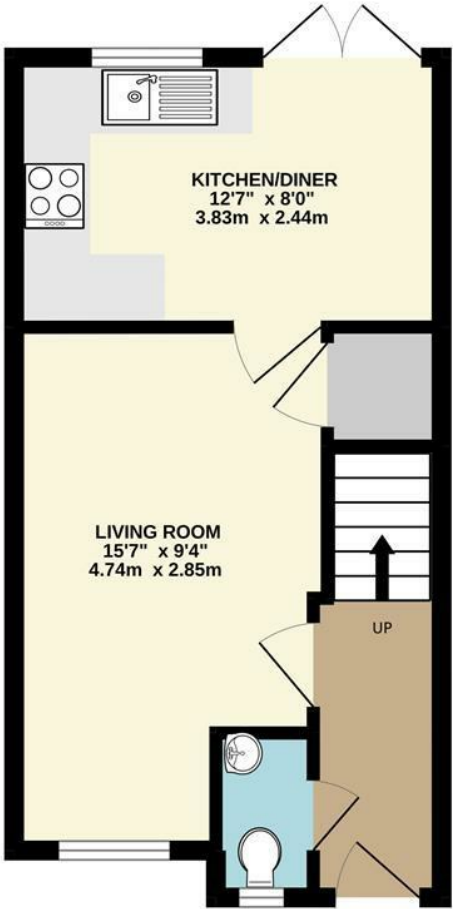

1ST FLOOR

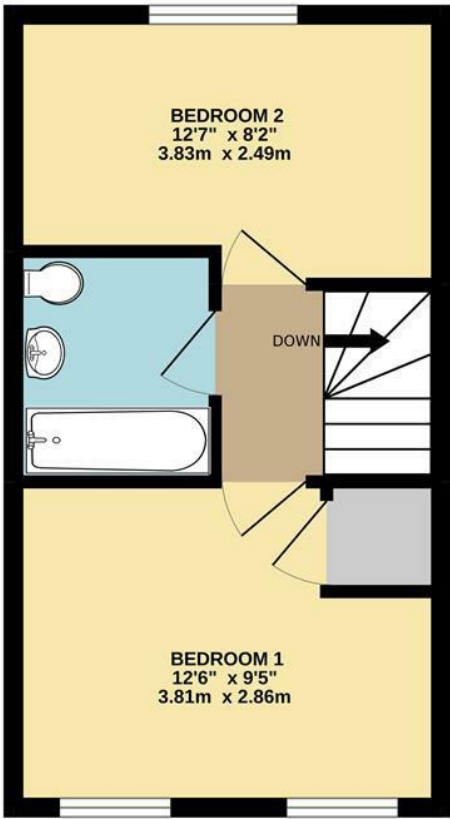

Whilst every attempt has been made to ensure the accuracy of the floorplan contained here, measurements of doors, windows, rooms and any other items are approximate and no responsibility is taken for any error, omission or mis-statement. This plan is for illustrative purposes only and should be used as such by any prospective purchaser. The services, systems and appliances shown have not been tested and no guarantee as to their operability or efficiency can be given.
Made with Metropix ©2022



SUMMARY

A well-presented two-bedroom house located on the newly built development of Hill Barton Vale. The property offers excellent access to local amenities including Sowton industrial estate, the MET office, City Centre, and major transport links surrounding the city including Junction 29 of the M5 motorway.

The accommodation comprises entrance hall, ground floor cloakroom, living room, kitchen/dining room, two double bedrooms, bathroom, and district heating. Outside is a delightful enclosed rear garden with paved patio area providing a pleasant seating area, and lawn area with mature shrubs. The property has two allocated parking spaces (in a tandem style).

Early internal viewing is highly recommended.

LETTINGS POTENTIAL

Naomi J Ryan Lettings Department have put an estimated rental value on this property of £1,100 per calendar month, providing a gross rental yield of 5.1%. If you would like further information regarding this or any aspect of letting a property, please contact our Lettings & Property Management Department.

VIEWING ARRANGEMENTS

Strictly by appointment with Naomi J Ryan Estate Agents.

360 VIRTUAL TOUR

A 360 degree Virtual Tour is available to view on our web site.

REFERRAL FEE DISCLOSURE

We recommend sellers and/or potential buyers use the services of The Mortgage Quarter. Should you decide to use the services of The Mortgage Quarter you should know that we would expect to receive a referral fee of £200 from them for recommending you to them. You are not under any obligation to use the services and can seek alternative providers of these services. Further information is available on our web site.



naomi j ryan
estate agents



THINKING OF SELLING?

Get in touch for a free,
no obligation valuation.
Call 01392 215283
or email
enquiries@naomijryan.co.uk

Energy Efficiency Rating	
	Potential
Very energy efficient - lower running costs	98
(92 plus) A	
(81-91) B	84
(69-80) C	
(55-68) D	
(39-54) E	
(21-38) F	
(1-20) G	
Not energy efficient - higher running costs	
England & Wales	EU Directive 2002/91/EC



BRITISH
PROPERTY
AWARDS

2022



GOLD WINNER

ESTATE AGENT
IN EXETER



IMPORTANT: we would like to inform prospective purchasers that these sales particulars have been prepared as a general guide only. A detailed survey has not been carried out, nor the services, appliances and fittings tested. Room sizes should not be relied upon for furnishing purposes and are approximate. If floor plans are included they are for guidance only and illustration purposes only and may not be to scale. If there are any important matters likely to affect your decision to buy, please contact us before viewing the property.

18 southernhay west, exeter, ex1 1pj
t&f . 01392 215283
e . enquiries@naomijryan.co.uk
www.naomijryan.co.uk
company registration number 6693899